

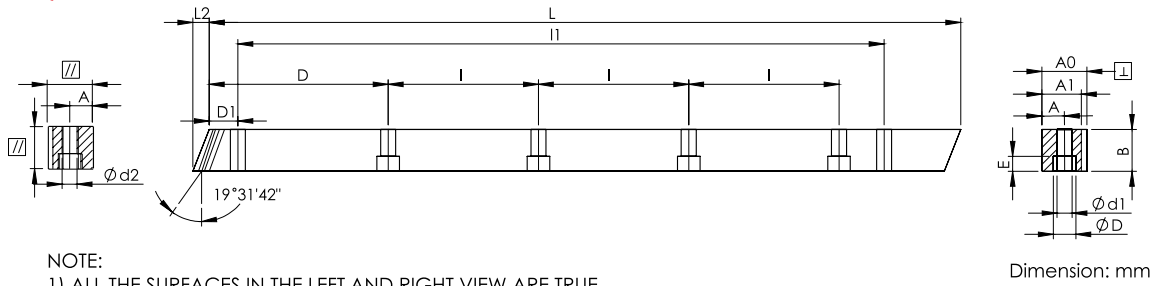

KCHRMQ-DIN8



- NOTE:
- 1) ALL THE SURFACES IN THE LEFT AND RIGHT VIEW ARE TRUE.
 - 2) ALL SURFACES HAVE Ra 1.6 SURFACE FINISH.
 - 3) ALL THE SURFACES ARE MILLED.

Series KCHRMQ-DIN8 Helical Milled Quenched and Tempered Racks
Quality Grade DIN 8

Material S50C
Right Hand Angle 19°31'42"
Hardness: HRC 50~55°
Total Pitch Error: $F_p / 1000 \leq 0.060$ mm
 $F_p / 2000 \leq 0.080$ mm

Code	Module	L	L2	No. of Teeth	B	A0	A1	D	I	No. of Holes	A	ød1	øD	E	D1	I1	ød2	f	F _{ta} kN	KG
KCHRMQ01510-DIN8	1.5	1000	6.00	200	17	17	15.5	62.5	125	8	7	6	9.5	7	31.7	936.6	5.7	1.5	0.88	2.1
KCHRMQ02010-DIN8	2	1000	8.90	150	25	24	22	62.5	125	8	8	7	11	7	31.7	936.6	5.7	2	1.73	4.3
KCHRMQ03010-DIN8	3	1000	10.60	100	30	29	26	62.5	125	8	9	10	15	9	35.0	930.0	7.7	2	3.11	6.2
KCHRMQ04010-DIN8	4	1000	14.20	75	40	39	35	62.5	125	8	12	10	15	9	33.3	933.4	7.7	2	5.52	11.1
KCHRMQ05010-DIN8	5	1000	17.40	60	49	39	34	62.5	125	8	12	14	20	13	37.5	925.0	11.7	3	8.46	13.6
KCHRMQ06010-DIN8	6	1000	20.90	50	59	49	43	62.5	125	8	16	18	26	17	37.5	925.0	15.7	3	12.22	20.5
KCHRMQ08010-DIN8	8	960	28.00	36	79	79	71	60	120	8	25	22	33	21	120.0	720.0	19.7	4	21.81	42.6
KCHRMQ08020-DIN8	8	1920	28.00	18	79	79	71	60	120	16	25	22	33	21	120.0	1680.0	19.7	4	21.81	85.1
KCHRMQ10010-DIN8	10	1000	35.11	30	99	99	89	62.5	125	8	32	33	48	32	125.0	750.0	19.7	5	34.17	69.6